

**ANCHOR BUILDING - WINDGATE HALL**

**WINDGATE HALL:** Located on the 5th floor of Anchor Building. From the Paradise Ballroom Foyer on the 6th floor, either take the parking garage elevator or the stairs down one floor to Windgate Hall.

**BEACON BUILDING MEETING ROOMS**

**COMPASS ROSE BALLROOM:** On the 7th floor of Anchor Building (floor above the Main Lobby), go down the Boardwalk, past all of the shops, down three flights of stairs to the Beacon Building Landing. At the Landing, take the short flight of carpeted stairs going up. The Compass Rose Ballroom is on the left.

**ISLAND:** On the 7th floor of Anchor Building (floor above the Main Lobby), go down the Boardwalk, past all of the shops, down the three flights of stairs to the Beacon Building Landing. At the Landing, take the short flight of plank steps down, go past the entrance of Fin City Bowling. Proceed down the ramp, turn right and go straight ahead into Island.

**ESCAPE:** On the 7th floor of Anchor Building (floor above the Main Lobby), go down the Boardwalk, past Margaritaville Store. Escape is on the right side of the hallway, across from Wood'n Ya Wanit.

**CORAL REEF:** On the 7th floor of Anchor Building (floor above the Main Lobby), go down the Boardwalk, past Wood'n Ya Wanit. Coral Reef is on the left.

**PORT:** On the 7th floor of Anchor Building (floor above the Main Lobby), go down the Boardwalk, past all of the shops and down one flight of stairs. Port is on the right.

**STARBOARD:** On the 7th floor of Anchor Building (floor above the Main Lobby), go down the Boardwalk, past all of the shops, down one flight of stairs. Starboard is on the left.

**CEDAR COVE:** On the 7th floor of Anchor Building (floor above the Main Lobby), go down the Boardwalk, past all of the shops, down two flights of stairs. Cedar Cove is on the left.

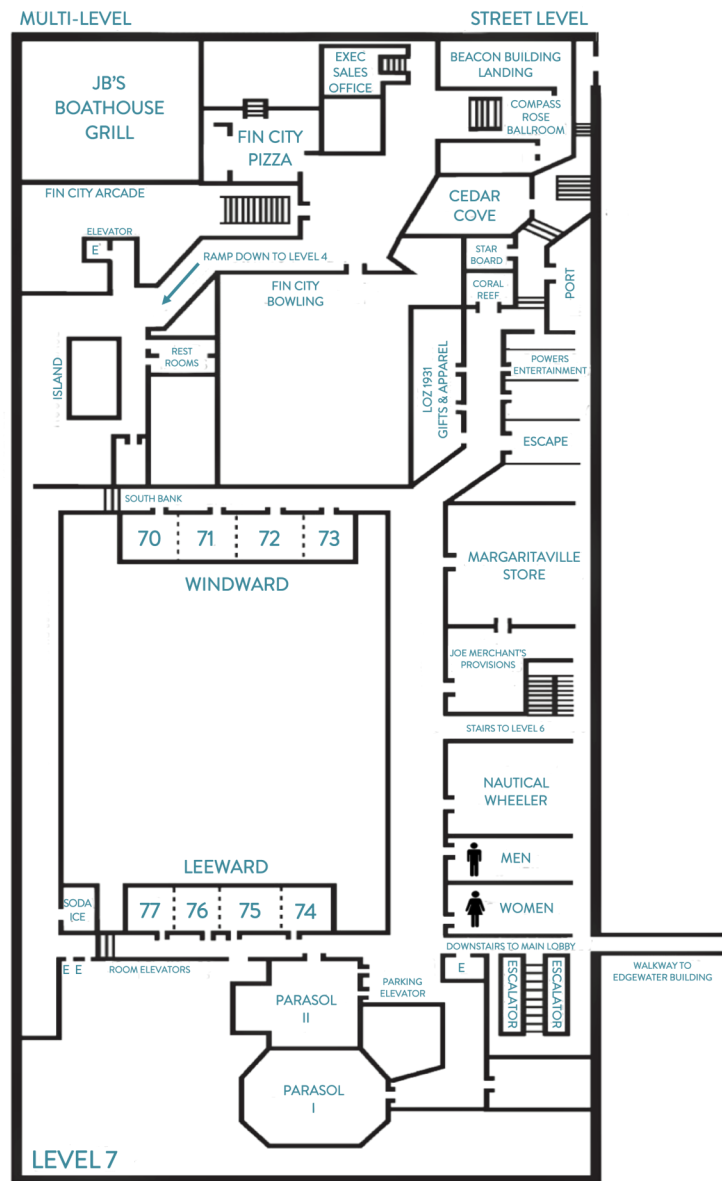

**BEACON BUILDING MEETING ROOMS**

**Having Trouble with Stairs?**

Take the connecting corridor from Anchor Building to Beacon Building: From Anchor Building, go to the double elevators where the guest rooms are located. Ride to level 4. Go through the guest room hallway, exiting at the far end. Turn left and follow the hallway to Beacon Building. If you are in a mobility assistance device and are unable to maneuver any amount of stairs, please contact Guest Services at Extension 5 or call (573) 348-8623 for assistance.

**MARGARITAVILLE**  
*Lake Resort*  
 LAKE OF THE OZARKS